

CONTACT PRECAUTIONS

Bed #

**Families
and
visitors:**



**Please report
to staff before
entering**

**Clean hands
before entering and
when leaving room**

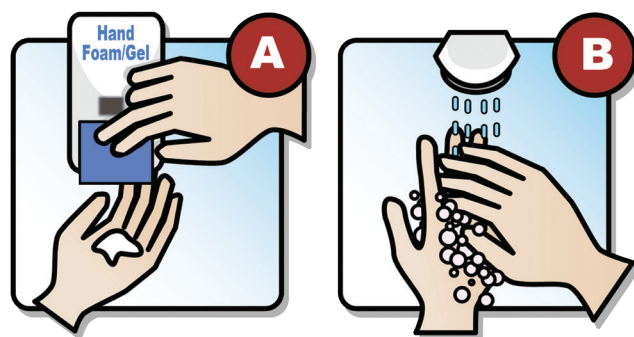

Clean hands with
A) hand foam/gel or **B)** soap and water

Staff:

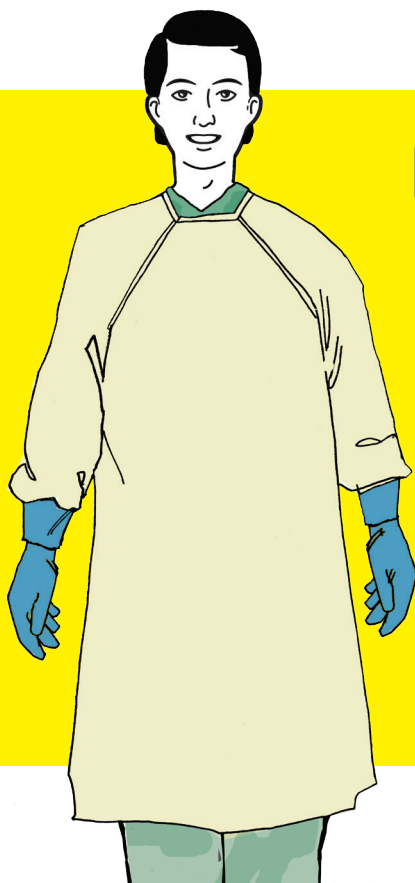

Required:

- Gown & Gloves

Point-of-Care Risk Assessment

When there is a risk
of splash or spray,
wear face and eye
protection.



**KEEP
SIGN POSTED
UNTIL ROOM
CLEANED**
HOUSEKEEPER will
remove sign after
"Discharge"
cleaning

For more information, refer to the Infection Control Manual.